

REF NO.:

DATE :

LOCATION DETAILS OF THE PROJECT OF LAND DEMARCATED FOR THE PROJECT DEVELOPMENT ALONG WITH ITS BOUNDARIES INCLUDING THE LATITUDE & LONGITUDE OF THE ENDPOINT OF THE PROJECT

PROJECT :

PROPOSED B + G + 7 STORIED RESIDENTIAL CUM COMMERCIAL BUILDING

NAME OF OWNERS :

1. VICTOR TRADELINK PRIVATE LIMITED REPRESENTED BY ITS DIRECTOR SMT. PREMLATA BIHANI
2. DEEPAK ENTERPRISES, REPRESENTED BY ONE OF ITS PARTNER SMT. PREMLATA BIHANI.

LAND SCHEDULE

MOUZA:- SILIGURI
 J.L. NO. :- 110(88)
 PLOT NO.- 259(R.S.),288(L.R.)
 KHATIAN NO.- 432, 433(R.S.),3343(L.R.)
 WARD NO. :- 2 UNDER S.M.C.
 P.O. & P.S. :- PRADHAN NAGAR
 SUB-DIV. AND
 A.D.S.R.O. :- SILIGURI
 PARGANA:- BAIKUNTHAPUR,
 DIST. :- DARJEELING.

GPS CO-ORDINATES:

LATITUDE: 26° 43' 49.77" N

LONGITUDE : 88° 24' 56.53" E

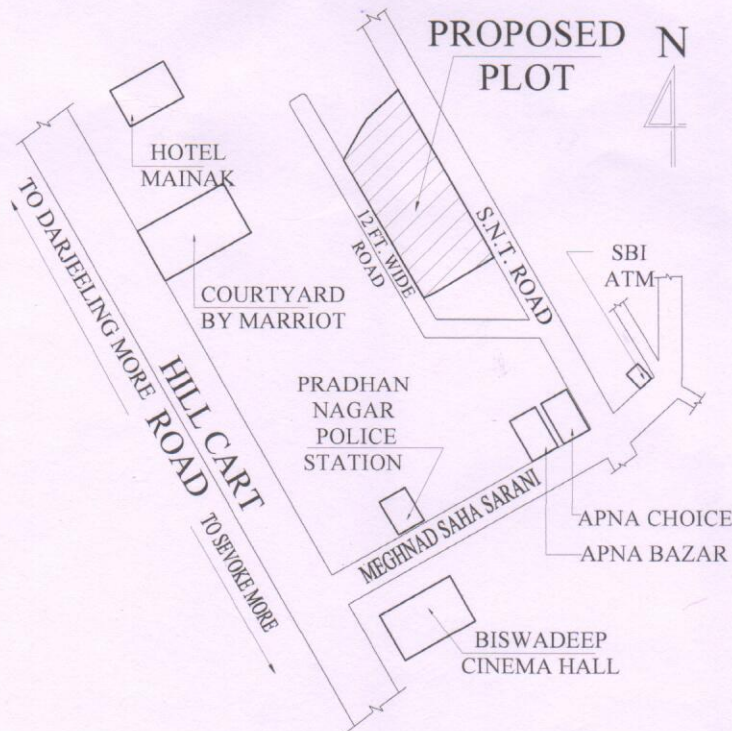

KEY PLAN

N.T.S.

Riwa Biswas
RIYA BISWAS (B.Arch)
CA/2019/112919

SIGNATURE OF ARCHITECT / L.B.S

DEEPAK ENTERPRISES

Premlata Bihani
Partner

SIGNATURE OF OWNERS